

## KWC BEVO Lever mixer - Basin

Modell-Linie: BEVO | 12.421.051.177FL  
Taps | Manual taps

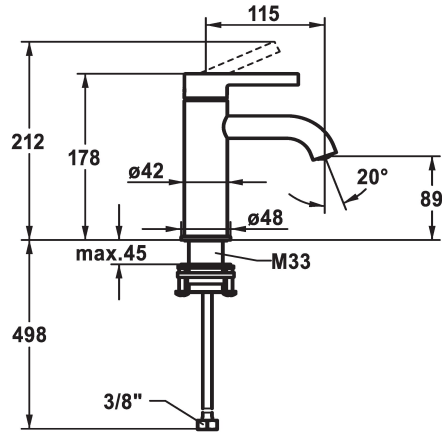

### KWC-No.

**125016**  
matt black, A 115, flexible connection hoses, with Push Open

**125017**  
matt black, A 115, flexible connection hoses, without pop-up valve

**125043**  
brushed steel, A 115, flexible connection hoses, with Push Open

**125044**  
brushed steel, A 115, flexible connection hoses, without pop-up valve

- \* Lever mixer
- \* EcoProtect - water-saving device
- \* Fixed spout
- Neoperl® Caché® CS, Coin Slot
- \* KWC cartridge M 35 OP
- with ceramic discs

### Pop-up\_valve

with Push open

without pop-up valve

with Push open

without pop-up valve

### Color code

matt black

matt black

brushed steel

brushed steel

- flow rate and temperature continuously variable
- temperature limitation
- \* Flexible connection hoses 3/8"
- \* QuickInstallation - Fastening via threaded connection with locking screws
- \* Mounting hole size ø35 mm

### Technical Data

Flow rate	5 l/min (3 bar)
Pop-up_valve	without pop-up valve
Connection	Flexible connection hoses
Spout	fixed
Handling	top lever
Color code	brushed steel
Installation_type	Pillar installation
Faucet_typ	Lever mixer
Dimension Height	178
G_Acoustic group	I
Projection_A	A 115
Energy Label	A
Dimension Water outlet	89
material	Brass

Flow rate	5 l/min (3 bar)
Pop-up_valve	without pop-up valve
Connection	Flexible connection hoses
Spout	fixed
Handling	top lever
Color code	brushed steel
Installation_type	Pillar installation
Faucet_typ	Lever mixer
Dimension Height	178
G_Acoustic group	I
Projection_A	A 115
Energy Label	A
Dimension Water outlet	89
material	Brass



### Spare Parts

**KWC BEVO**  
Lever mixer - Basin

**Modell-Linie: BEVO | 12.421.051.177FL**  
Taps | Manual taps



**Cartridge M 35 OP**

---

**538331**  
Z.537.710

---