

KWC BEVO Trim kit - Lever mixer - Tub

Modell-Linie: BEVO | 20.424.510.000
Duschar | Badkarsarmaturer



KWC-No.

124634
chromeline, Trim kit

124636
chromeline, Trim kit, with vacuum breaker

125027
matt black, Trim kit

125028
matt black, Trim kit, with vacuum breaker

125054
brushed steel, Trim kit

125055
brushed steel, Trim kit, with vacuum breaker

ATT-KWC-FARBCODE

chromeline

chromeline

matt black

matt black

brushed steel

brushed steel

ATT-KWC-UNTERPUTZ

FM-Set

FM-Set mit SI

FM-Set

FM-Set mit SI

FM-Set

FM-Set mit SI

- * Trim kit with function unit
- * Outflow top and below
- * Turning handle for diverter
- * KWC cartridge M 35 H
- with ceramic discs
- flow rate and temperature continuously variable
- * Scope of delivery:

- Function unit, lever, cap, sleeve, cover plate, holder for escutcheon, diverter
- Fastening of the cover plate without screws
- * To be ordered separately:
- Unit for concealed installation KWC BLUEBOX®
- ½", without shut-off valve, 39.999.900.931
- ¾" (½"), with shut-off valve, 39.999.910.931

Technical Data

ATT-KWC-A_ABGANG_UP

Diameter

Handling

ATT-KWC-FARBCODE

Installation_type

Faucet_typ

G_Acoustic_group

ATT-KWC-UNTERPUTZ

EnergyLabelCH

Material

19 l/min (3 bar)

D170

frontbedient

chromeline

Väggmontering

Hebelmischer

I

FM-Set mit SI

C

Mässing



Extratillbehör

KWC BEVO

Trim kit - Lever mixer - Tub

Modell-Linie: BEVO | 20.424.510.000
Duschar | Badkarsarmaturer

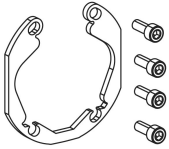

BLUEBOX Alignment set

537593
Z.537.593

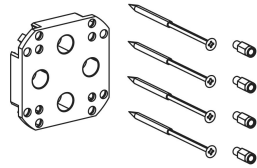

BLUEBOX Extension set 15 mm

537595
Z.537.595

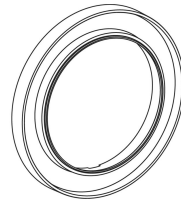

BLUEBOX Excutechon extension

537600
Z.537.600

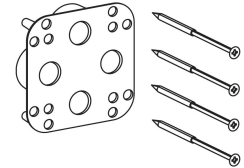

BLUEBOX Reverse adapter

537953
Z.537.953

Reservdelar



Cartridge M 35 H

538327
Z.537.582